

# NOVABLADE FLUSH MOUNT

LL9PS123SK Series NovaBlade Mounting Accessories



## PRODUCT OVERVIEW

Novablade products are a fantastic light source, and while the majority of applications are in a t-bar ceiling systems where they just drop into place, Novablade can do much more with the help of specialised mounting frames. The flush mount frame brings the t-bar fit into plasterboard ceilings. It's the neatest way to have great light on hand without a luminaire in sight. It fits flush with the ceiling and requires as little as 150mm clearance in the ceiling. Once installed, the Novablade just drops into place, as with a t-bar ceiling grid.

### Features at a Glance

- For flush-fitting Novablade panels into plasterboard ceilings
- Rigid aluminium frame powder-coated in matte white to suit standard ceiling colours
- Allows ease of installation of Lumex LL9P3 series panels
- Driver secured discreetly behind panel when mounted in flush mount frame
- Safety cables provided
- Seven year warranty

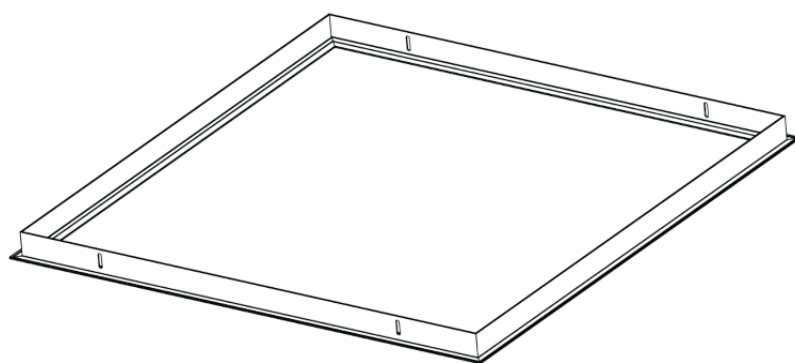

### Construction

**Colour Finish:** White satin powdercoat

**Material:** Extruded Aluminium

### Installation

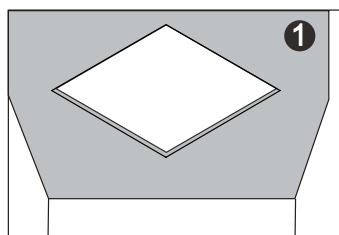

1. Cut hole in ceiling

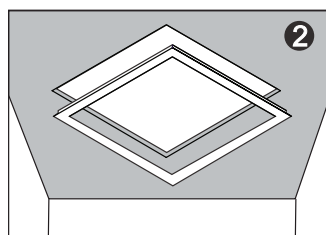

2. Fix the Flush Mount to the hole

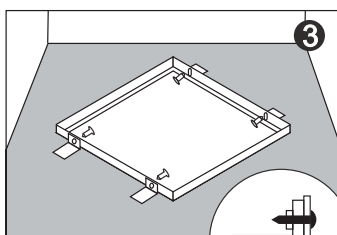

3. Fix the Flush Mount to the ceiling with the screws and L-bracket

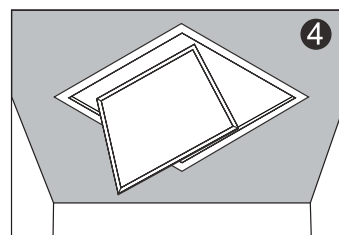

4. Place the panel into the Flush Mount frame

### Part Numbers & Dimensions

Part Number	Panel Size	Frame Size	Cut-Out
LL9P63FK	295 x 595 x 10mm	332 x 632 x 31mm	315 x 615mm
LL9P66FK	595 x 595 x 10mm	632 x 632 x 31mm	615 x 615mm
LL9P123FK	295 x 1195 x 10mm	332 x 1232 x 31mm	315 x 1215mm
LL9P126FK	595 x 1195 x 10mm	632 x 1232 x 31mm	615 x 1215mm

Specifications subject to change without notice.



**CUSTOMER SERVICE**  
**+61 (03) 9790 8999**  
**verbatimlighting.com.au**

